



PADDINGTON EXCHANGE, 6 HERMITAGE STREET
LONDON, W2
Asking Price £1,200,000 Leasehold

T. +44 (0) 20 7935 0011
E. enquire@napierwatt.co.uk
WWW.NAPIERWATT.CO.UK

NAPIER WATT
PROPERTY CONSULTANTS

Description

A 2 bedroom apartment with wheelchair access, located on the second floor of Paddington Exchange, a recent development in one of the most well-connected areas in London where cool bars, stylish restaurants and designer shopping are all within easy walking distance.

The property comprises two double bedrooms with fitted wardrobes, open plan reception dining area with access to the terrace along with a spacious hallway which houses the utility area and storage room. All residents will have access to an on-site Car Club (operated by Zipcar). Parking can be available by arrangement.

This is Zone 1 living at its best, in the heart of one of the most well-connected areas in London. With an extensive over-ground and underground rail network, Paddington Exchange is ideally situated for daily commuting. For business travellers, the Heathrow Express adjacent to Paddington Station will take you to the airport in only 15 minutes.

Council Tax F Westminster

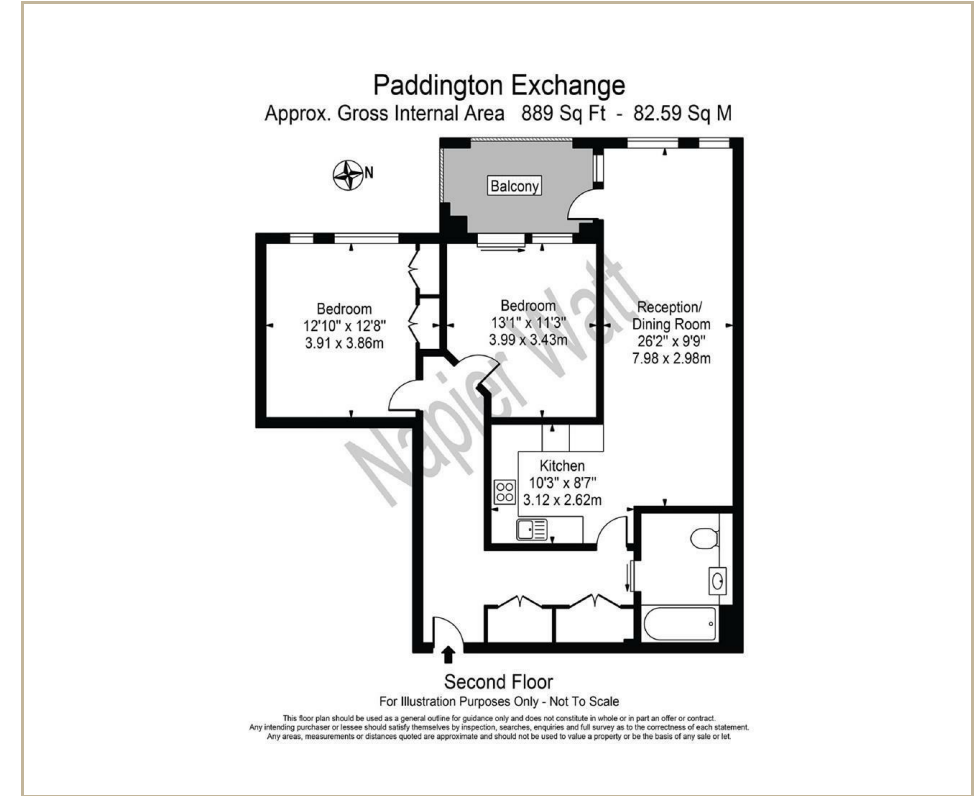

TERMS

999 years (less 3 days) commencing on 27 March 2014 - 994years
Council Tax F Westminster

For Clarification we wish to inform prospective purchasers that we have prepared these sales particulars as a general guide. We have not carried out a survey, nor tested the services, appliances and specific fittings. Room sizes are approximate and rounded: they are taken between internal wall surfaces and therefore include cupboards/shelves, etc. Accordingly, they should not be relied upon for carpets and furnishings. Formal notice is given that all fixtures and fittings, carpeting, curtains/blinds and kitchen equipment, whether fitted or not, are deemed to be removable by the vendor unless specifically itemised within these sales particulars.

T. +44 (0) 20 7935 0011
E. enquire@napierwatt.co.uk
WWW.NAPIERWATT.CO.UK

NAPIER WATT
PROPERTY CONSULTANTS